

# ON/OFF LIGHTING RELAY SWITCH



## Features

With its two channels, the ON/OFF Lighting Relay Switch enables the user to connect and remotely control one or two lights with a wireless and battery-free controller (wall switch, remote, ...). It is easy to install, without building work, behind a wired wall switch, on the ceiling or in the electrical panel.



### SIGNAL REPEATER

The relay switch repeats all messages from all others EnOcean devices



### ULTRA LOW PROFILE

Installation in electrical boxes from >30mm



### INSTALLATION AT THE ELECTRICAL PANEL

DIN Rail Box\*\*\* needed



### REMOTE COMMISSIONING

Wireless installation without physical intervention

## Technical specifications

**Power supply:** 230V AC ~ 50Hz

**Switching capabilities:** 230V AC - 2 x 5A

**Consumption:** <1W

**Maximum output power:** 2 x 1.150W (resistive load)

See page 7 - List of compatible loads available on [www.nodon.fr/loads](http://www.nodon.fr/loads)

**Radio frequency range:** 868.0 to 868.6 MHz

**RF power max:** +3dBm

**Range:** up to 30m indoors

**Operational temperature:** -10°C to 40°C

**Protection rating:** IP 30

**Pairing:** up to 22 controllers

**EEP (EnOcean Profile):** D2-01-12

## Renovation



Creation of a new back-and-forth with a wireless and battery-less wall switch



Redesigning hassle free: individual lighting control



Automatic or remote control of room lights

## Serenity



Presence simulation: automatically turn the lights ON/OFF\*

## Comfort



Central and smart management of lighting thanks to motion detection

\*Home automation gateway needed

## Installation



**N** Terminal for the Neutral

**L** Terminal for the Line

**1** Input terminal for the wired switch 1\*\*

**2** Input terminal for the wired switch 2\*\*

**1** Output 1 (controlled by 1)

**2** Output 2 (controlled by 2)

**Note:** Each terminal can accept a cable of 2.5mm<sup>2</sup> maximum

\*\*Wired switch optional (see the installation diagrams section on the next page)

**Wiring of the ON/OFF Lighting Relay Switch in the DIN Rail Box\*\*\***



\*\*\*DIN Rail Box page 18

## Dimensions

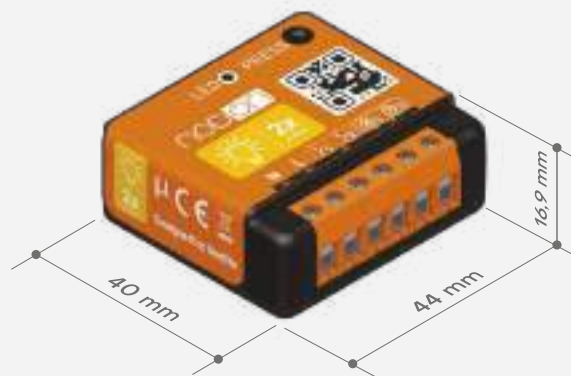

## Reference

SIN-2-2-XX - EAN: 3700313921371

# ON/OFF Lighting Relay Switch wiring diagrams

## For two lights with a double wired switch

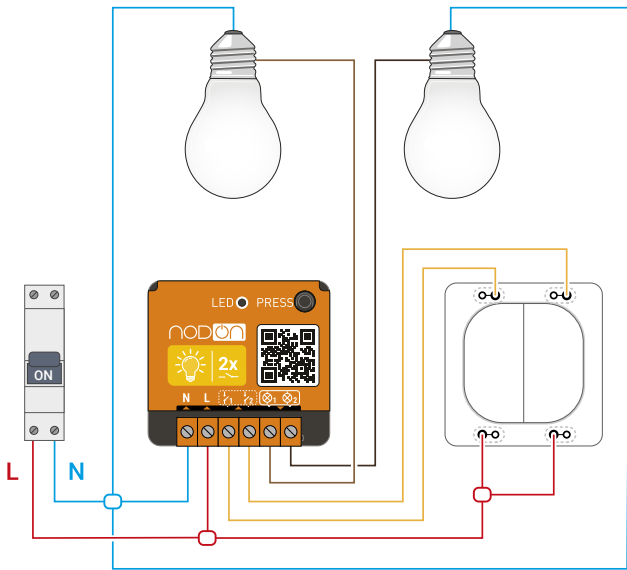

## For one light with a single wired switch

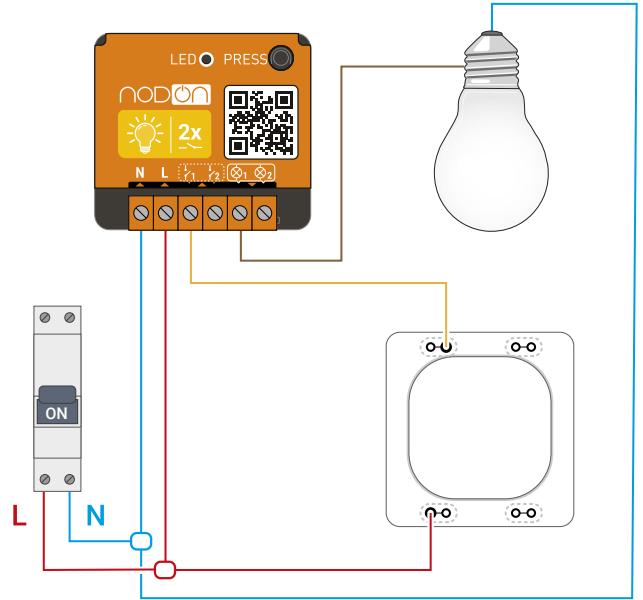

## Without wired switch

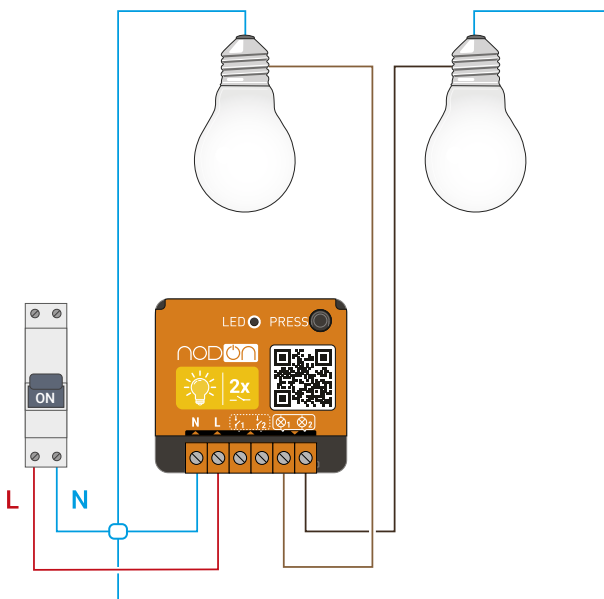

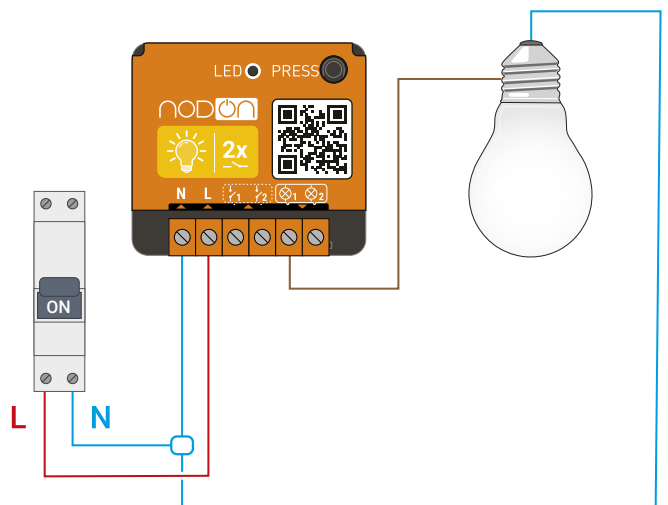

## On the ceiling







# Lightings compatible with the ON/OFF Lighting Relay Switch



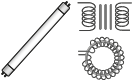



## Resistive loads

Light type		P. Max
	Incandescent light	1100W
	Halogen lamp 230V	1100W

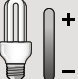
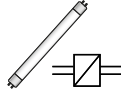
## Inductive loads

Light type		P. Max
	Neon with ferromagnetic ballast	 <i>Not compatible</i>
	Gas-discharge lamp / Metal halide lamp	 <i>Not compatible</i>

## Capacitive loads

Light type		P. Max
	Standard energy-saving lamp	80W
	Dimmer energy-saving lamp	80W
	Neon with electronic ballast	100W
	LED lamp 230V	500W
	Filament LED	90W
	LED lamp 12V with converter	80W
	HPS	 <i>Not compatible</i>